

Important: (1) Normal maintenance and adjustments to the product is the responsibility of the customer. (2) Normal wear and tear is not covered under warranty. (3) Rubber/plastic parts and consumables such as blades, clutch and clutch-bell, spark-plugs, nylon line, air-filters, fuel-filters, oil seals etc. are not covered under the warranty.

No Warranty On Electrical Motor / Electrical Parts / Battery Etc.

Incidental / Consequential Loss: KisanKraft Limited or its manufacturers will not be liable for general damages, including bodily injuries, or for incidental or consequential damages including, but not limited to, loss of use, loss of profits, loss of production, expense of substitute equipment or other commercial loss or damage.

Limitation of Liability: This limited warranty is in lieu of all other express warranties, obligations, or liabilities. Any implied warranties, obligations or liabilities, including, but not limited to, any implied warranty of merchantability shall be limited in duration to the applicable warranty period. Any action for breach of any warranty hereunder, including, but not limited to, any implied warranty of merchantability must be brought within the applicable warranty period.

Modifications of Warranty: No agent, representative, dealer, or employee of KisanKraft Limited or any of its manufacturers has the authority to increase or alter the obligations of this warranty.

Assignment / Transfer of warranty: The warranty cannot be assigned and shall not transfer if the product is resold by the first buyer. The above warranties are extended to the first end user (original purchaser), and no warranty is made, nor authorized to be made assignable on resale by the first end user.

What you must do to obtain limited warranty service: To obtain performance of any obligation under this warranty for failure during the applicable warranty period, deliver the defective product, to the nearest Authorized Dealer. KisanKraft Limited, its manufacturers and its dealers reserve the right to inspect the claimed defective part(s) to determine if the malfunction is the result of a defect covered by this warranty. Please note that the decision of KisanKraft Ltd with respect to any warranty claim is final.

Receipt is required for availing warranty services

Jurisdiction: All disputes are subject to Bangalore court's jurisdiction.

Our Products	<ul style="list-style-type: none"> ◆Chainsaws◆Brush Cutters and Accessories◆Harvesters◆ ◆Engines and Water Pumps◆Hand Tools◆Garden Tools◆ ◆Cultivators and Accessories◆Sprayers and Accessories◆ ◆Transplanter and Post Hole Digger ◆Milking Machines◆
---------------------	--

This warranty is null & void, if you fail to register the warranty with KisanKraft by sending the KisanKraft Copy with dealer's stamp.

KisanKraft Limited (formerly known as KisanKraft Machine Tools P Ltd)

🌐: www.kisankraft.com

✉: info@kisankraft.com

☎: +91.80.22178200

Product	Agricultural Reaper (Baffle Type) / Shoulder Mounted Baffle Type Reaper	KisanKraft Invoice Date	
Brand	KisanKraft	KisanKraft Invoice No.	
Model	<input type="checkbox"/> KK-BC2-JP45 <input type="checkbox"/> KK-SBC2-JP43		
WARRANTY PERIOD	6 MONTHS	FOR THE SPECIFIED PERIOD FROM THE DATE OF SALE OR DELIVERY WHICHEVER IS EARLIER.	
Dealer's Invoice Date		Dealer's Invoice No.	
Buyer's Info (Name, Address, Phone, etc.):		Dealer's Stamp (Address, Phone, TIN, etc.):	
Buyer's Sign		Dealer's Sign	

What is covered: KisanKraft Limited and its manufacturers warrant this product to be free from defects in material or workmanship. All parts defective in material and workmanship are covered.

This warranty will only cover defects arising under normal usage.

This warranty is limited to repair or replacement by KisanKraft Limited or its manufacturers at the premises of Authorized Dealers, of such parts as appear to KisanKraft or its manufacturers, upon inspection, to be defective in material and/or workmanship. KisanKraft or its manufacturers make no warranty with respect to trade accessories not manufactured or sold by them.

What is not covered: The warranty shall become null and void and neither KisanKraft Limited nor any of its manufacturers, nor its authorized dealers assumes any responsibility, if the failure was caused by the following:

(1) Operation of product with incorrect fuel or lubricants, (2) Incorrect usage of machine or misuse, (3) Lack of maintenance, (4) Negligence, (5) Accident or physical damage, (6) Repairs made by unauthorized parties and/or with unauthorized parts, (7) Improper set up, adjustments, tampering or altered products

Note: The purchase is not contingent upon a product demonstration. The purchaser shall satisfy himself with the product, including any product demonstration or verification of any function, before buying. KisanKraft Limited or its authorized dealers, including online sellers, shall not be liable to give any on-site demonstration after purchase of any of the product.

This warranty is null & void, if you fail to register the warranty with KisanKraft by sending the KisanKraft Copy with dealer's stamp.

KisanKraft Limited (formerly known as KisanKraft Machine Tools P Ltd)

🌐: www.kisankraft.com

✉: info@kisankraft.com

☎: +91.80.22178200

Important: (1) Normal maintenance and adjustments to the product is the responsibility of the customer. (2) Normal wear and tear is not covered under warranty (3) Rubber/plastic parts and consumables such as blades, clutch and clutch-bell, spark-plugs, nylon line, air-filters, fuel-filters, oil seals etc. are not covered under the warranty.

No Warranty On Electrical Motor / Electrical Parts / Battery Etc.

Incidental / Consequential Loss: KisanKraft Limited or its manufacturers will not be liable for general damages, including bodily injuries, or for incidental or consequential damages including, but not limited to, loss of use, loss of profits, loss of production, expense of substitute equipment or other commercial loss or damage.

Limitation of Liability: This limited warranty is in lieu of all other express warranties, obligations, or liabilities. Any implied warranties, obligations or liabilities, including, but not limited to, any implied warranty of merchantability shall be limited in duration to the applicable warranty period. Any action for breach of any warranties hereunder, including, but not limited to, any implied warranty of merchantability must be brought within the applicable warranty period.

Modifications of Warranty: No agent, representative, dealer, or employee of KisanKraft Limited or any of its manufacturers has the authority to increase or alter the obligations of this warranty.

Assignment / Transfer of warranty: The warranty cannot be assigned and shall not transfer if the product is resold by the first buyer. The above warranties are extended to the first end user (original purchaser), and no warranty is made, nor authorized to be made assignable on resale by the first end user.

What you must do to obtain limited warranty service: To obtain performance of any obligation under this warranty for failure during the applicable warranty period, deliver the defective product, to the nearest Authorized Dealer. KisanKraft Limited, its manufacturers and its dealers reserve the right to inspect the claimed defective part(s) to determine if the malfunction is the result of a defect covered by this warranty. Please note that the decision of KisanKraft Ltd with respect to any warranty claim is final.

Receipt is required for availing warranty services

Jurisdiction: All disputes are subject to Bangalore court's jurisdiction.

Our Products	<ul style="list-style-type: none"> ◆Chainsaws◆Brush Cutters and Accessories◆Harvesters◆ ◆Engines and Water Pumps◆Hand Tools◆Garden Tools◆ ◆Cultivators and Accessories◆Sprayers and Accessories◆ ◆Transplanter and Post Hole Digger ◆Milking Machines◆
---------------------	--

This warranty is null & void, if you fail to register the warranty with KisanKraft by sending the KisanKraft Copy with dealer's stamp.

KisanKraft Limited (formerly known as KisanKraft Machine Tools P Ltd)

🌐: www.kisankraft.com ✉: info@kisankraft.com ☎: +91.80.22178200

Product	Agricultural Reaper (Baffle Type) / Shoulder Mounted Baffle Type Reaper	KisanKraft Invoice Date	
Brand	KisanKraft	KisanKraft Invoice No.	
Model	<input type="checkbox"/> KK-BC2-JP45 <input type="checkbox"/> KK-SBC2-JP43		
WARRANTY PERIOD	6 MONTHS	FOR THE SPECIFIED PERIOD FROM THE DATE OF SALE OR DELIVERY WHICHEVER IS EARLIER.	
Dealer's Invoice Date		Dealer's Invoice No.	
Buyer's Info (Name, Address, Phone, etc.):		Dealer's Stamp (Address, Phone, TIN, etc.):	
Buyer's Sign		Dealer's Sign	

What is covered: KisanKraft Limited and its manufacturers warrant this product to be free from defects in material or workmanship. All parts defective in material and workmanship are covered.

This warranty will only cover defects arising under normal usage.

This warranty is limited to repair or replacement by KisanKraft Limited or its manufacturers at the premises of Authorized Dealers, of such parts as appear to KisanKraft or its manufacturers, upon inspection, to be defective in material and/or workmanship. KisanKraft or its manufacturers make no warranty with respect to trade accessories not manufactured or sold by them.

What is not covered: The warranty shall become null and void and neither KisanKraft Limited nor any of its manufacturers, nor its authorized dealers assumes any responsibility, if the failure was caused by the following:

(1) Operation of product with incorrect fuel or lubricants, (2) Incorrect usage of machine or misuse, (3) Lack of maintenance, (4) Negligence, (5) Accident or physical damage, (6) Repairs made by unauthorized parties and/or with unauthorized parts, (7) Improper set up, adjustments, tampering or altered products

Note: The purchase is not contingent upon a product demonstration. The purchaser shall satisfy himself with the product, including any product demonstration or verification of any function, before buying. KisanKraft Limited or its authorized dealers, including online sellers, shall not be liable to give any on-site demonstration after purchase of any of the product.

This warranty is null & void, if you fail to register the warranty with KisanKraft by sending the KisanKraft Copy with dealer's stamp.

KisanKraft Limited (formerly known as KisanKraft Machine Tools P Ltd)

🌐: www.kisankraft.com ✉: info@kisankraft.com ☎: +91.80. 22178200

Wide Range of Products for Every Need



For more information give **MISSED CALL: 07676065555**



Many of our products have BIS: ISI certification.



User Manual

KK-BC2-JP45

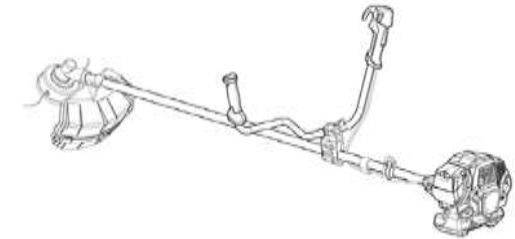

KK-SBC2-JP43

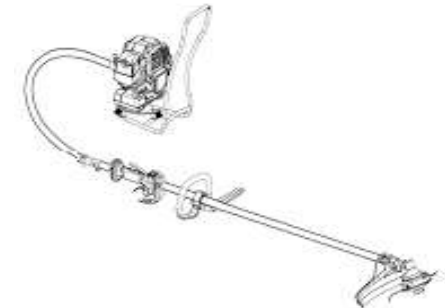

KisanKraft Limited

(Formerly known as KisanKraft Machine Tools Pvt Ltd)

Sri Huchhanna Tower, #4, 1st Main, 7-A Cross, Maruthi Layout, Dasarahalli,
HAF Post, Hebbal, Bangalore 560024, Karnataka, INDIA

- ♦ Bangalore (HO) ♦ Ahmedabad ♦ Bhopal ♦ Bhubaneswar ♦ Coimbatore ♦
- ♦ Guwahati ♦ Hyderabad ♦ Jaipur ♦ Karnal ♦ Kolkata ♦
- ♦ Lucknow ♦ Jammu ♦ Pune ♦ Raipur ♦ Shimla ♦

KisanKraft has a large range of products to serve the farmers. A list of our products is given below:

<p>Brush Cutters and Accessories</p> <ul style="list-style-type: none"> Brush Cutter/Power Weeder Backpack Brush Cutter Tea Pruner Pole pruner with Engine Reaper Attachment Blades-Circular Blades (2 & 3 points) Baffle Nylon Rope Tap & Go <p>Chainsaws</p> <ul style="list-style-type: none"> Petrol Chainsaw Electric Chainsaw Chain Sharpening Machine <p>Engines and Water Pumps</p> <ul style="list-style-type: none"> Engine –Diesel-(Horizontal) Engine –Diesel(Vertical) Engine-Kerosene Water Pump with Petrol Engine Water Pump with Kerosene Engine Water Pump with Diesel Engine <p>Hand Tools</p> <ul style="list-style-type: none"> Secateurs Folding Saw Garden Rake Garden Shovel Hedge Shear Lopper Telescopic Hedge Shear Telescopic Lopping Shear Tree Pruner Telescopic Steel Pipe & Fruit Picker Bag Sheep Shear <p>Garden Tools</p> <ul style="list-style-type: none"> Electric Pressure Washer Hedge Trimmer Lawn Mower (Electric, Petrol & Manual) Leaf Blower 	<p>Cultivators and Accessories</p> <ul style="list-style-type: none"> Petrol and Diesel <p>Sprayers and Accessories</p> <ul style="list-style-type: none"> Battery Sprayer Portable Power Sprayer Trolley Sprayer Manual Knapsack Sprayer Manual Pressure Sprayer Rose Cans Hose Crimping Machine HTP Sprayer HTP Delivery Hose HTP Hose Reel HTP Stand HTP Gun / Lance(Brass Rod) Knapsack Power Sprayer Mister / Duster / Granuel Spreader HTP Sprayer Set with Diesel Engine HTP Sprayer Set with Kerosene Engine Fogging Machine <p>Milking Machine</p> <ul style="list-style-type: none"> Wood Shredder Fodder Ensiling Chaff Cutter Fodder Grinder Chaff Cutter Fodder Mini Chaff Cutter <p>Harvester</p> <ul style="list-style-type: none"> Maize Sheller Maize Sheller + Dehusker Maize Combine Harvester Onion Digger Carlotti Italy Tea Leaf Harvester Sugarcane Combine Harvester Sugarcane Leaf Stripper <p>Transplanter and Post Hole Digger</p> <ul style="list-style-type: none"> Paddy Transplanter (2 & 8 Rows) Transplanter-Vegetable & Tobacco Post Hole Digger(4" to 14" Augers)
--	---

Technical Specifications

Technical data	Unit	KK-BC2-JP45	KK-SBC2-JP43
Engine displacement	cm ³	42.7	
Maximum engine power	kW	1.14 (1.52hp)	1.27kW
Weight (without fuel, harness, cutting attachment and guard)	kg	8.24	10.62
Maximum engine rotation speed	min-1	9500 for grass trimmer, 11500 for brush cutter	9300 for grass trimmer, 11000 for brush cutter
Speed of output shaft	min-1	7350 for grass trimmer, 8900 for brush cutter	7200 for grass trimmer, 8500 for brush cutter
Idling speed range	min-1	2800±200	3100±400
Spark plug		NGK BPMR8Y	
Mixture (petrol: 2-stroke oil)		40:1	
Fuel tank capacity	ml	1100	
Operator ear noise pressure level	dB(A)	96.2	102.3
Measurement uncertainty	dB(A)	3	3
Measured acoustic power level	dB(A)	112.1	
Measurement uncertainty	dB(A)	3	
Acoustic power level guaranteed	dB(A)	115	
Vibration level			
- Right handle	m/s ²	3.74	3.58
- Left handle	m/s ²	4.15	3.96
Measurement uncertainty	m/s ²	1.5	1.5

Note: Technical specifications are subject to change without prior notice.

Recommended cutting attachment	Type	Cutting width (mm)	Thickness of blade/ diameter of cutting line (mm)	Blade center hole diameter (mm)
Blade	3 teeth, single piece, metal	255	1.6 or 3.0	25.4
	4 teeth, single piece, metal	255	1.4	25.4
Trimmer head	Non-metallic Flexible cutting line	430	2.4	

CONTENTS

Before Getting Started.....	8
Getting to Know Machine	8
Parts Identification-KK-BC2-JP45	10
Parts Identification-KK-SBC2-JP43	11
Safety Regulations	12
1. Important.....	12
2. Personal Protective Equipment	13
3. Machine's Safety Equipment	13
4. Cutting Attachment	16
Operating Instructions-KK-BC2-JP45.....	18
Operating Instructions-KK- SBC2-JP43	20
Fuel Handling	24
Using the Machine.....	26
General Working Instructions	28
Routine Maintenance	32
Maintenance Timescale	34
Troubleshooting	35
Technical Specifications	36

Product	Agricultural Reaper (Baffle Type) / Shoulder Mounted Baffle Type Reaper	KisanKraft Invoice Date	
Brand	KisanKraft	KisanKraft Invoice No.	
Model	<input type="checkbox"/> KK-BC2-JP45 <input type="checkbox"/> KK-SBC2-JP43		
WARRANTY PERIOD	6 MONTHS	FOR THE SPECIFIED PERIOD FROM THE DATE OF SALE OR DELIVERY WHICHEVER IS EARLIER.	
Dealer's Invoice Date		Dealer's Invoice No.	
Buyer's Info (Name, Address, Phone, etc.):		Dealer's Stamp (Address, Phone, TIN, etc.):	
Buyer's Sign		Dealer's Sign	

What is covered: KisanKraft Limited and its manufacturers warrant this product to be free from defects in material or workmanship. All parts defective in material and workmanship are covered.

This warranty will only cover defects arising under normal usage.

This warranty is limited to repair or replacement by KisanKraft Limited or its manufacturers at the premises of Authorized Dealers, of such parts as appear to KisanKraft or its manufacturers, upon inspection, to be defective in material and/or workmanship. KisanKraft or its manufacturers make no warranty with respect to trade accessories not manufactured or sold by them.

What is not covered: The warranty shall become null and void and neither KisanKraft Limited nor any of its manufacturers, nor its authorized dealers assumes any responsibility, if the failure was caused by the following:

(1) Operation of product with incorrect fuel or lubricants, (2) Incorrect usage of machine or misuse, (3) Lack of maintenance, (4) Negligence, (5) Accident or physical damage, (6) Repairs made by unauthorized parties and/or with unauthorized parts, (7) Improper set up, adjustments, tampering or altered products

Note: The purchase is not contingent upon a product demonstration. The purchaser shall satisfy himself with the product, including any product demonstration or verification of any function, before buying. KisanKraft Limited or its authorized dealers, including online sellers, shall not be liable to give any on-site demonstration after purchase of any of the product.

Troubleshooting

Source of problem	Probable cause	Corrective action
1. The engine will not start or will not keep running	Incorrect starting procedure	Follow the operating instructions
	Dirty spark plug or incorrect distance between the electrodes	Check the spark plug
	Air filter clogged	Clean or replace the filter
	Carburation problems	Contact your Dealer
2. The engine starts but is lacking in power	Air filter clogged	Clean or replace the filter
	Carburation problems	Contact your Dealer
3. The engine runs irregularly and lacks in power when revved	Dirty spark plug or incorrect distance between the electrodes	Check the spark plug
	Carburation problems	Contact your Dealer
4. The engine emits too much smoke	Incorrect composition of the fuel mixture	Prepare the fuel mixture according to the instructions
	Carburation problems	Contact your Dealer
5. The machine starts to vibrate abnormally	Damaged or loose parts	Stop the machine and disconnect the spark plug cable. Inspect for damage. Check for and tighten any loose parts. Have all checks, repair work and replacements carried out by a specialized Centre only.

This warranty is null & void, if you fail to register the warranty with KisanKraft by sending the KisanKraft Copy with dealer's stamp.

KisanKraft Limited (formerly known as KisanKraft Machine Tools P Ltd)

Maintenance Timescale

The following intervals apply to normal operating conditions only. If your daily working time is longer or operating conditions are difficult (very dusty work area, etc.), shorten the specified intervals accordingly.		Before starting working	After finishing work daily	After each refueling stop	Weekly	Monthly	Every 12 months	If problem	If damaged	If required
Complete machine	Visual inspection (condition, wear, leaks)	■		■						
	Clean		■							
Control handle	Check operation	■		■						
Air filter	Clean					■		■		■
	Replace								■	■
Fuel filter	Check					■		■		
	Replace filter						■		■	■
Carburetor	Check idle setting	■		■						
	Readjust idle									■
Spark plug	Readjust electrode gap						■	■		
	Replace after 100 hours of operation									
Cooling inlets	Clean					■				■
All accessible screws	Check				■			■		
	Retighten									■
Anti - vibration elements	Check	■						■		■
	Replace									
Safety labels	Replace								■	
Muffler	Clean								■	

Note: Use only the spare parts recommended by KisanKraft.

Important: (1) Normal maintenance and adjustments to the product is the responsibility of the customer. (2) Normal wear and tear is not covered under warranty.

(3) Rubber/plastic parts and consumables such as blades, clutch and clutch-bell, spark-plugs, nylon line, air-filters, fuel-filters, oil seals etc. are not covered under the warranty.

No Warranty On Electrical Motor / Electrical Parts / Battery Etc.

Incidental / Consequential Loss: KisanKraft Limited or its manufacturers will not be liable for general damages, including bodily injuries, or for incidental or consequential damages including, but not limited to, loss of use, loss of profits, loss of production, expense of substitute equipment or other commercial loss or damage.

Limitation of Liability: This limited warranty is in lieu of all other express warranties, obligations, or liabilities. Any implied warranties, obligations or liabilities, including, but not limited to, any implied warranty of merchantability shall be limited in duration to the applicable warranty period. Any action for breach of any warranty hereunder, including, but not limited to, any implied warranty of merchantability must be brought within the applicable warranty period.

Modifications of Warranty: No agent, representative, dealer, or employee of KisanKraft Limited or any of its manufacturers has the authority to increase or alter the obligations of this warranty.

Assignment / Transfer of warranty: The warranty cannot be assigned and shall not transfer if the product is resold by the first buyer. The above warranties are extended to the first end user (original purchaser), and no warranty is made, nor authorized to be made assignable on resale by the first end user.

What you must do to obtain limited warranty service: To obtain performance of any obligation under this warranty for failure during the applicable warranty period, deliver the defective product, to the nearest Authorized Dealer. KisanKraft Limited, its manufacturers and its dealers reserve the right to inspect the claimed defective part(s) to determine if the malfunction is the result of a defect covered by this warranty. Please note that the decision of KisanKraft Ltd with respect to any warranty claim is final.

Receipt is required for availing warranty services

Jurisdiction: All disputes are subject to Bangalore court's jurisdiction.

Our Products

- ◆Chainsaws◆Brush Cutters and Accessories◆Harvesters◆
- ◆Engines and Water Pumps◆Hand Tools◆Garden Tools◆
- ◆Cultivators and Accessories◆Sprayers and Accessories◆
- ◆Transplanter and Post Hole Digger ◆Milking Machines◆

This warranty is null & void, if you fail to register the warranty with KisanKraft by sending the KisanKraft Copy with dealer's stamp.

KisanKraft Limited (formerly known as KisanKraft Machine Tools P Ltd)

Before Getting Started

Before using the machine for the first time be sure to read through this manual in order to avoid wrong operation. Please preserve this manual properly so that it can provide you with information whenever necessary.

HOW TO READ THE MANUAL

Certain paragraphs in the manual contain particularly significant information and are marked with various levels of highlighting with the following meaning:

NOTE or IMPORTANT

These give details or further information on what has already been said, and aim to prevent damage to the machine or cause other damage.



Non- observance will result in the risk of serious injury or death to oneself or others.

Getting to Know Machine

Information of Symbols



≤ 8250 n/min

WARNING! A brush cutter or trimmer can be dangerous if used incorrectly or carelessly, and can cause serious or fatal injury to the operator or others. It is extremely important that you read and understand the contents of this owner's manual. Please read the operator's manual carefully and make sure you understand the instructions before using the machine.

Always wear:

- A protective helmet where there is a risk of falling object
- Approved hearing protection and eye protection

Always wear approved protective gloves

Wear sturdy, non - slip boots.

Max. speed of output shaft, min - 1

5.4 Bevel gear



The bevel gear is filled with the right quantity of grease at the factory. However, before using the machine you should check that the bevel gear is filled three - quarters full with grease. The grease in the bevel gear does not normally need to be changed except if repairs are carried out.

5.5 Spark plug

The spark plug condition is influenced by:

Incorrect carburetor adjustment.

An incorrect fuel mixture (too much or incorrect type of oil).

A dirty air filter.

These factors cause deposits on the spark plug electrodes, which may result in operating problems and starting difficulties.

If the machine is low on power, difficult to start or runs poorly at idle speed: always check the spark plug first before taking any further action. If the spark plug is dirty, clean it and check that the electrode gap is 0,6 - 0,7 mm. The spark plug should be replaced after about a month in operation or earlier if necessary.

Recommended Spark plug type:

Always use the recommended spark plug type! Use of the wrong spark plug can damage the piston/ cylinder. Check that the spark plug is fitted with a suppressor.

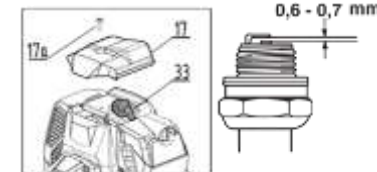

Turn the screw (17a) counter - clockwise to remove the top cover (17), and then open the spark plug cap (33) to remove the spark plug for maintenance.

Routine Maintenance

5.1 Carburetor

Adjusting the idle speed (T)

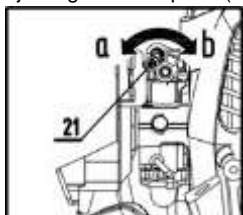

Check that the air filter is clean. When the idle speed is correct, the cutting attachment should not rotate. If adjustment is required, open (turn clockwise "b") the idle adjustment screw T (21), with the engine running, until the cutting attachment starts to rotate. Close (turn anticlockwise "a") the screw until the cutting attachment stops. The idle speed is correctly set when the engine runs smoothly in all positions, and there is a clear margin to the speed at which the cutting attachment starts to rotate. **If the idle speed cannot be adjusted so that the cutting attachment stops, contact your dealer/service workshop. Do not use the machine until it has been correctly adjusted or repaired.**

5.2 Air filter

The air filter must be regularly cleaned to remove dust and dirt in order to avoid:

- Carburetor malfunctions
- Starting problems
- Loss of engine power
- Unnecessary wear to engine parts
- Excessive fuel consumption

Clean the filter every 25 hours, or more regularly if conditions are exceptionally dusty.

Cleaning the air filter

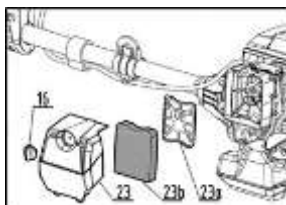

Turn the Air filter cover screw (16) Counter-clockwise to remove the screw and the air filter cover (23), and then take out the oil baffle plate (23a) and air filter (23b). Wash them in warm, soapy water. Ensure that the air filter is dry before refitting it. An air filter that has been in use for a long time cannot be cleaned completely. The filter must therefore be replaced with a new one at regular intervals. A damaged air filter must always be replaced.

5.3 Fuel filter



When the engine runs short of fuel supply, check the fuel filter for blockage.



Machines fitted with saw blades or grass blades can be thrown violently to the side when the blade comes into contact with a fixed object. This is called blade thrust. The blade is capable of amputating an arm or leg. Always keep people and animals at least 15 meters from the machine.

Watch out for thrown objects and ricochets.



Do not use saw blades

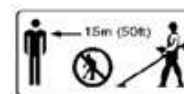

The operator of the machine must ensure, while working, that no persons or animals come closer than 15 meters.



Guarantee A - weighted emission noise power level



Fuel mixture tank

Parts Identification-KK-BC2-JP45

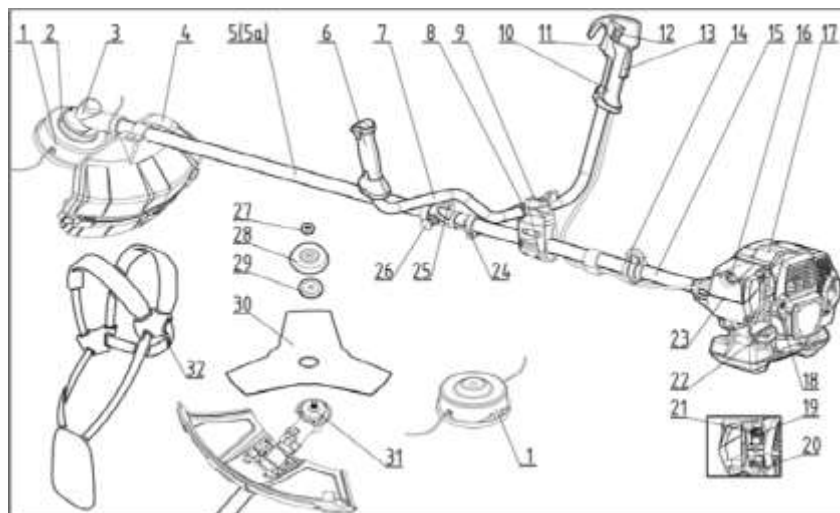

- | | |
|---------------------------------|---------------------------|
| 1. Trimmer head | 17. Top cover |
| 2. Top protecting cap | 18. Starter handle |
| 3. Gear box | 19. Fuel enrich knob |
| 4. Cutting attachment guard | 20. Primer bulb |
| 5. Drive shaft tube | 21. Idle screw |
| 5a Front tube | 22. Fuel tank cap |
| 6. Left handle | 23. Air filter cover |
| 7. Handle bar | 24. Connector |
| 8. Clamping cover | 25. Locking knob |
| 9. Locking screw | 26. Locking pin |
| 10. Right handle | 27. Locking nut |
| 11. Throttle trigger | 28. Bottom Protecting cap |
| 12. Engine switch | 29. Bottom clamping plate |
| 13. Throttle trigger lock - out | 30. Metal blade |
| 14. Suspension ring | 31. Top clamping plate |
| 15. Rear tube | 32. Harness |
| 16. Air filter cover screw | |

4.4.2 Clearing



- The clearing technique removes all unwanted vegetation. Keep the trimmer head just above the ground and tilt it. Let the end of the cord strike the ground around trees, posts, statues and the like. **CAUTION!** This technique increases the wear on the cord.
- The cord wears quicker and must be fed forward more often when working against stones, brick, concrete, metal fences, etc., than when coming into contact with trees and wooden fences.
- When trimming and clearing you should use less than full throttle so that the cord lasts longer and to reduce the wear on the trimmer head.

4.4.3 Cutting



- The trimmer is ideal for cutting grass that is difficult to reach using a normal lawn mower. Keep the cord parallel to the ground when cutting. Avoid pressing the trimmer head against the ground as this can ruin the lawn and damage the tool.
- Do not allow the trimmer head to constantly come into contact with the ground during normal cutting. Constant contact of this type can cause damage and wear to the trimmer head.

4.4.4 Sweeping

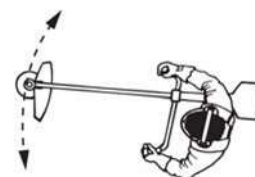

- The fan effect of the rotating cord can be used for quick and easy clearing up. Hold the cord parallel to and above the area to be swept and move the tool to and fro.
- When cutting and sweeping you should use full throttle to obtain the best results.

direction, and possibly lose control of the machine. Blade thrust can occur without warning if the machine snags, stalls or binds. Blade thrust is more likely to occur in areas where it is difficult to see the material being cut.

- Avoid cutting with the area of the blade between the 12 o'clock and 3 o'clock positions. Because of the speed of rotation of the blade, blade thrust can occur if you attempt to cut thick stems with this area of the blade.

4.3 Grass clearing using a grass blade

- Grass blades and grass cutters must not be used on woody stems.
- A grass blade is used for all types of tall or coarse grass.
- The grass is cut down with a sideways, swinging movement, where the movement from right - to - left is the clearing stroke and the movement from left - to - right is the return stroke. Let the left - hand side of the blade (between 8 and 12 o' clock) do the cutting.



- If the blade is angled to the left when clearing grass, the grass will collect in a line, which makes it easier to collect, e.g. by raking.
- Try to work rhythmically. Stand firmly with your feet apart. Move forward after the return stroke and stand firmly again.
- Let the support cup rest lightly against the ground. It is used to protect the blade from hitting the ground.
- Reduce the risk of material wrapping around the blade by following these instructions:
 - Always work at full throttle.
 - Avoid the previously cut material during the return stroke.
- Stop the engine, unclip the harness and place the machine on the ground before you start to collect the cut material.

4.4 Grass trimming with a trimmer head

4.4.1 Trimming

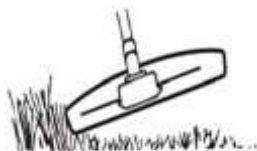

- Hold the trimmer head just above the ground at an angle. It is the end of the cord that does the work. Let the cord work at its own pace. Never press the cord into the area to be cut.
- The cord can easily remove grass and weeds up against walls, fences, trees and borders, however it can also damage sensitive bark on trees and bushes, and damage fence posts.
- Reduce the risk of damaging plants by shortening the cord to 10 - 12 cm and reducing the engine speed.

Parts Identification-KK-SBC2-JP43

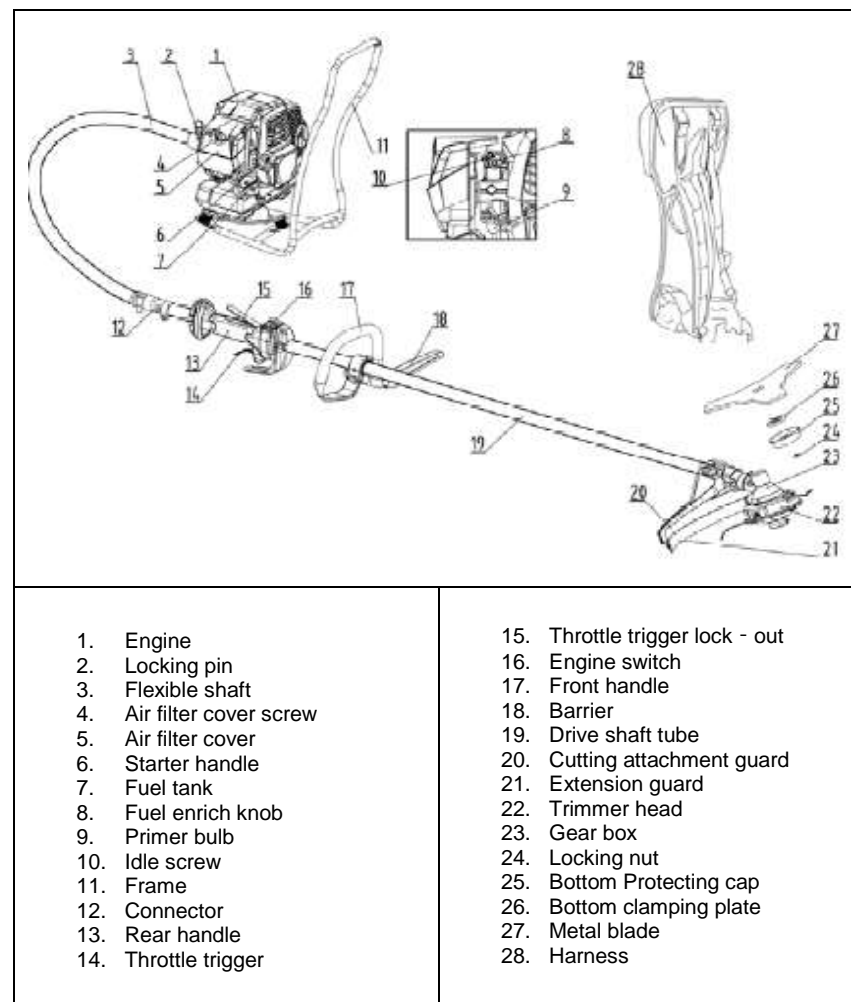

Safety Regulations

1. Important

- The machine is only designed for trimming grass and cutting bushes. The only accessories you can operate with this engine unit are the recommended cutting attachments
- Never use the machine if you are tired, ill, have drunk alcohol, or if you are taking medication that could affect your vision, your judgement or your coordination.
- Wear personal protective equipment. See instructions under the heading "Personal protective equipment".
- Never use a machine that has been modified in any way from its original specification.
- Never use a machine that is faulty. Carry out the checks, maintenance and service instructions described in this manual. Some maintenance and service measures must be carried out by trained and qualified specialists. See instructions under the heading "Routine maintenance".
- All covers, guards and handles must be fitted before starting. Ensure that the spark plug cap and ignition lead are undamaged to avoid the risk of electric shock.
- The machine operator must ensure that no people or animals come closer than 15 meters while working.
- Never allow children or people unfamiliar with these instructions to use the machine.
- Local laws can restrict the minimum age of the operator.
- Secure the machine during transport to prevent loss of fuel, damage or injury; Cleaning and maintenance before storage, including the use of guards on cutting attachments with metal blades;
- Use of a transport cover for metal blades during transport and storage;
- Alert! National regulations (Occupational Safety and Health, environment) may be present, which can restrict the use of the machine;
- Daily inspect the machine before use and after dropping or other impacts to identify any significant defects;
- Keep firm footing and balance during operation, use the harness provided;
- During a working day, you shall take frequent and adequate breaks to prevent damage from vibration and damage to the ears.
- During a working day, you shall take frequent and adequate breaks to prevent damage from vibration and damage to the ear, and change working positions frequently.

WARNING

- This machine produces an electromagnetic field during operation. This field may under some circumstances interfere with active or passive medical implants. To reduce the risk of serious or fatal injury, we recommend persons with medical implants to consult their physician and the medical implant manufacturer before operating this machine.
- The exhaust gases emitted from engine contain dangerous carbon monoxide.
- Running an engine in a confined or badly ventilated area can result in death due to asphyxiation or carbon monoxide poisoning.

- Inspect the working area. Remove all loose objects, such as stones, broken glass, nails, steel wire, string, etc. that could be thrown out or become wrapped around the cutting attachment.
- Do not use the machine in bad weather, such as dense fog, heavy rain, strong wind, intense cold, etc. Working in bad weather is tiring and often brings added risks, such as icy ground, unpredictable felling direction, etc.



- Make sure you can move and stand safely. Check the area around you for possible obstacles (roots, rocks, branches, ditches, etc.) in case you have to move suddenly.
- Take great care when working on sloping ground.
- Keep a good balance and a firm foothold.
- Always hold the machine with both hands. Hold the machine on the right side of your body.
- Keep the cutting attachment below waist level.
- Switch off the engine before moving to another area. Fit the transport guard before carrying or transporting the equipment any distance.
- Never put the machine down with the engine running unless you have it in clear sight.

WARNING

- Neither the operator of the machine nor anyone else may attempt to remove the cut material while the engine is running or the cutting equipment is rotating, as this can result in serious injury.
- Stop the engine and cutting equipment before you remove material that has wound around the blade shaft as otherwise there is a risk of injury. The bevel gear can get hot during use and may remain so for a while afterwards. You could get burnt if you touch it.
- Watch out for thrown objects. Always wear approved eye protection. Never lean over the cutting attachment guard. Stones, rubbish, etc. can be thrown up into the eyes causing blindness or serious injury.
- Keep unauthorized persons at a distance. Children, animals, onlookers and helpers should be kept outside the safety zone of 15 m. Stop the machine immediately if anyone approaches. Never swing the machine around without first checking behind you to make sure no one is within the safety zone.

4.2 Basic working techniques

Always slow the engine to idle speed after each working operation. Long periods at full throttle without any load on the engine can lead to serious engine damage.

WARNING

- Sometimes branches or grass get caught between the guard and cutting attachment. Always stop the engine before cleaning.
- Machines fitted with grass blades can be thrown violently to the side when the blade comes into contact with a fixed object. This is called blade thrust. A blade thrust can be violent enough to cause the machine and/or operator to be propelled in any

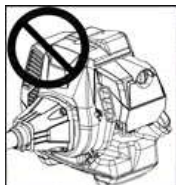

Do not pull the starter cord all the way out and do not let go of the starter handle when the cord is fully extended. This can damage the machine.

Do not put any part of your body in marked area. Contact can result in burns to the skin, or electrical shock if the spark plug cap has been damaged. Always use gloves. Do not use a machine with damaged spark plug cap.

3.2.2 Hot starting

To hot start the engine immediately after it has stopped, follow steps a – c – d of the above procedure, making sure the primer bulb is activated 2 - 3 times only.

3.2.3 Stopping:



Stop the engine by switching off the ignition.

General Working Instructions

IMPORTANT! This section describes the basic safety precautions for working with brush cutters and trimmers.

If you encounter a situation where you are uncertain how to proceed you should ask an expert. Contact your dealer or your service workshop.

Avoid all usage which you consider to be beyond your capability.

You must understand the difference between forestry clearing, grass clearing and grass trimming before use.

4.1 Basic safety rules



Look around you:

- To ensure that people, animals or other things cannot affect your control of the machine.
- To ensure that people, animals, etc., do not come into contact with the cutting attachment or loose objects that are thrown out by the cutting attachment.
- Do not use the machine unless you are able to call for help in the event of an accident.

- Prolonged exposure to vibrations can cause injuries and neurovascular disorders (also called “Raynaud’s syndrome” or “white hand”), especially to people suffering from circulation disorders. The symptoms can regard the hands, wrists and fingers and are shown through loss of sensitivity, torpor, itching, pain and discoloring of or structural changes to the skin. These effects can be worsened by low ambient temperatures and/or by gripping the handgrips excessively tightly. If the symptoms occur, the length of time the machine is used must be reduced and a doctor consulted.

2. Personal Protective Equipment

IMPORTANT You must use approved personal protective equipment whenever you use the machine. Personal protective equipment cannot eliminate the risk of injury but it will reduce the degree of injury if an accident does happen. Ask your dealer for help in choosing the right equipment.

Listen out for warning signals or shouts when you are wearing hearing protection.

Always remove your hearing protection as soon as the engine stops.

Helmet: A protective helmet where there is a risk of falling objects.

Hearing and Eye Protection: Wear hearing protection that provides adequate noise reduction. Always wear approved eye protection.

Gloves: Gloves should be worn when necessary, e.g., when fitting cutting attachments.

Boots: Wear boots with steel toe caps and non-slip sole.

Clothing: Wear clothes made of a strong fabric and avoid loose clothing that can catch on twigs and branches. Always wear heavy, long pants. Do not wear jewellery, shorts sandals or go barefoot. Secure hair so it is above shoulder level.

First Aid Kit: Always have a first aid kit nearby.

3. Machine’s Safety Equipment

WARNING! Never use a machine with faulty safety equipment. The machine’s safety equipment must be checked and maintained as described in this section. If your machine fails any of these checks contact your service agent to get it repaired.



3.1 Throttle trigger lock - out

The throttle trigger lockout is designed to prevent accidental operation of the throttle trigger. When you press the trigger lock - out (13) (i.e. when you grasp the handle) it releases the throttle trigger (11). When you release the handle the throttle trigger and the throttle trigger lock - out both move back to their original positions. This movement is controlled by two independent return springs. This arrangement means that the throttle trigger is automatically locked at the idle setting.

Make sure the throttle trigger is locked at the idle setting when the throttle trigger lock - out is released.



Press the throttle trigger lock - out and make sure it returns to its original position when you release it.



Check that the throttle trigger and throttle trigger lock - out move freely and that the return springs work properly. See instructions under the heading Start. Start the machine and apply full throttle. Release the throttle trigger and check that the cutting attachment stops and remains at a standstill. If the cutting attachment rotates with the throttle in the idle position then the carburetor idle setting must be checked. (See instructions under the heading Maintenance)



3.2 Engine Switch



Press down the "O" side of the engine switch to stop the engine.
Start the engine and make sure the engine stops when you move the engine switch to the stop setting.

3.3 Cutting Attachment Guard

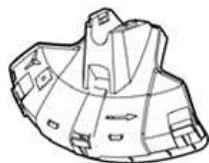

This guard is intended to prevent loose objects from being thrown towards the operator. The guard also protects the operator from accidental contact with the cutting attachment. Check that the guard is undamaged and not cracked. Replace the guard if it has been exposed to impact or is cracked.

Always use the recommended guard for the cutting attachment you are using.

Never use a cutting attachment without an approved guard.

See the chapter on Technical data. If an incorrect or faulty guard is fitted this can cause serious personal injury.

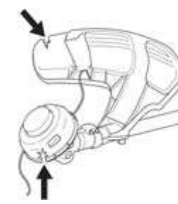

- Check that the trimmer head and trimmer guard are not damaged or cracked. Replace the trimmer head or trimmer guard if they have been exposed to impact or are cracked.

3.2 Starting and Stopping

- **The complete clutch cover and shaft must be fitted before the machine is started, otherwise the clutch can come loose and cause personal injury.**
- **Always move the machine away from the refueling area before starting. Place the machine on a flat surface. Ensure the cutting attachment cannot come into contact with any object.**
- **Make sure no unauthorized persons are in the working area, otherwise there is a risk of serious personal injury. The safety distance is 15 meters.**

3.2.1 Cold starting: A "cold" start of the engine means starting it after at least 5 minutes from when it was switched off or after refueling.

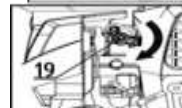

- Starting: Ignition: Press down the "I" side of the engine switch.
- Start aid: turn the fuel enrich knob (19) clockwise to the "START" position.
NOTE The fuel enrich knob will automatically return to "RUN" position once the throttle trigger is activated.
- Primer bulb: Press the primer bulb (20) repeatedly until fuel
- Hold the body of the machine on the ground using your left hand (CAUTION! Not with your foot!). Grip the starter handle, slowly pull out the cord with your right hand until you feel some resistance (the starter pawls grip), and now quickly and powerfully pull the cord. Never twist the starter cord around your hand.
Repeat pulling the cord until engine starting. When the engine starts, allow the engine to warm up with the throttle pulled slightly. Begins to fill the bulb.
The bulb need not be completely filled.

- If the machine is not used for some time the fuel tank should be emptied and cleaned.

2.7 Fueling

- Taking the following precautions, will lessen the risk of fire:
- Do not smoke or place hot objects near fuel.
- Always shut off the engine before refueling.
- Always stop the engine and let it cool for a few minutes before refueling.
- When refueling, open the fuel cap slowly so that any excess pressure is released gently.
- Tighten the fuel cap carefully after refueling.
- Always move the machine away from the refueling area before starting.
 - Always use a fuel container with an anti - spill valve.
 - Clean the area around the fuel cap. Contamination in the tank can cause operating problems.
 - Ensure that the fuel is well mixed by shaking the container before filling the tank.

Using the Machine

3.1 Check and starting

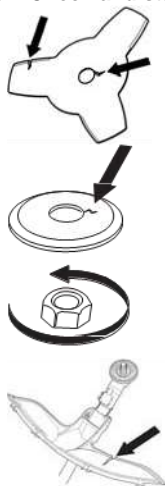

- Never use the machine without a guard nor with a defective guard.
- All covers must be correctly fitted and undamaged before you start the machine.
- Check the blade to ensure that no cracks have formed at the bottom of the teeth or by the center hole. The most common reason why cracks are formed is that sharp corners have been formed at the bottom of the teeth while sharpening or that the blade has been used with dull teeth. Discard a blade if cracks are found.
- Check that the support flange is not cracked due to fatigue or due to being tightened too much. Discard the support flange if it is cracked.
- Ensure the locking nut has not lost its captive force. The nut lock should have a locking force of at least 1.5 Nm. The tightening torque of the locking nut should be 35 - 50 Nm.
- Check that the blade guard is not damaged or cracked. Replace the blade guard if it is exposed to impact or is cracked.

3.4 Vibration Damping System

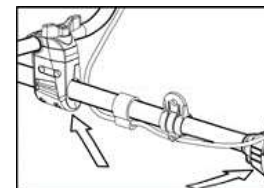

Your machine is equipped with two vibration damping systems that are designed to minimize vibration and make operation easier.

Using incorrectly wound cord or a blunt or incorrect cutting attachment (wrong type or incorrectly filed, see instructions under the heading Filing the blade) increases the level of vibration.

The machine's vibration damping systems reduces the transfer of vibration between the engine unit/cutting equipment and the machine's handle unit.

Regularly check the vibration damping units for cracks or deformation. Check that the vibration damping element is undamaged and securely attached

3.5 Quick Release

There is an easily accessible, quick release fitted near the suspension ring as a safety precaution in case the engine catches fire, or in any other situation that requires you to free yourself from the machine.

3.6 Muffler



The muffler is designed to keep noise levels to a minimum and to direct exhaust fumes away from the user.

Never use a machine that has a faulty muffler.

Regularly check that the muffler is securely attached to the machine

The inside of the muffler contain chemicals that may be carcinogenic. Avoid contact with these elements in the event of a damaged muffler.

Bear in mind that: The exhaust fumes from the engine are hot and may contain sparks which can start a fire. Never start the machine indoors or near combustible material!

3.7 Locking nut



A locking nut is used to secure some types of cutting attachment.

When fitting, tighten the nut in the opposite direction to the direction of rotation of the cutting attachment. To remove it, undo the nut in the same direction as the cutting attachment rotates. (CAUTION! The nut has a left - hand thread.) Tighten the nut using the socket spanner.

The nylon lining inside the locking nut must not be so worn that you can turn it by hand. The lining should offer a resistance of at least 1.5 Nm. The nut should be replaced after it has been put on approx. 20 times.

4. Cutting Attachment

This section describes how to choose and maintain your cutting equipment in order to:

- Reduce the risk of blade thrust.
- Obtain maximum cutting performance.
- Extend the life of cutting equipment.

IMPORTANT Only use cutting attachments with the guards we recommend! Refer to the instructions for the cutting attachment to check the correct way to load the cord and the correct cord diameter.

Keep the teeth of the blade correctly sharpened! Follow our recommendations. Also refer to the instructions on the blade packaging.



Always stop the engine before doing any work on the cutting attachment. This continues to rotate even after the throttle has been released. Ensure that the cutting attachment has stopped completely and disconnect the HT lead from the spark plug before you start to work on it. Using an incorrect cutting attachment or an incorrectly sharpened blade increases the risk of blade thrust.

4.1 Cutting attachment

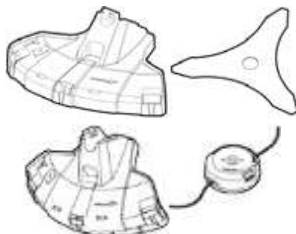

Grass blades and grass cutters are intended for cutting coarse grass.

A trimmer head is intended for trimming grass.

General rules

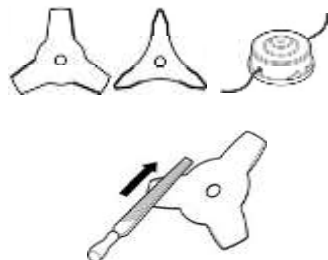

Only use cutting attachments with the guards we recommend! Never to use other cutting attachment like metal multi - piece pivoting chains and flail blades which are not recommended, if used it's likely to lead to mechanical hazards to operator.

Keep the teeth of the blade correctly sharpened! Follow our instructions and use the recommended file gauge. An incorrectly sharpened or damaged blade increases the risk of accidents.

2.4 Petrol

Always use a quality petrol/oil mixture at least 90 octane (RON). If your machine is equipped with a catalytic converter always use a good quality unleaded petrol/oil mixture.

Leaded petrol will destroy the catalytic converter.

Use low - emission petrol, also known as alkylate petrol, if it is available.

The lowest octane recommended is 90 (RON). If you run the engine on a lower octane grade than 90 so - called knocking can occur. This gives rise to a high engine temperature, which can result in serious engine damage.

When working at continuous high revs a higher octane rating is recommended.



2.5 Two-stroke oil

Petrol, liter	Two- stroke oil, milliliter
	2.5% (1:40)
1	25
5	125
10	250
20	500

- For best results and performance use two - stroke engine oil, which is specially formulated for our air - cooled two - stroke engines.
- Never use two - stroke oil intended for water - cooled engines, sometimes referred to as outboard oil (rated TCW).
- Never use oil intended for four - stroke engines.
- A poor oil quality and/or too high oil/fuel ratio may jeopardize function and decrease the life time of catalytic converters.
- Mixing ratio: 1:40 (2.5%) with JASO FC or ISO EGD grade formulated for air - cooled, two - stroke engines.

2.6 Mixing

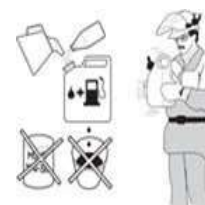

- Always mix the petrol and oil in a clean container intended for fuel.
- Always start by filling half the amount of the petrol to be used. Then add the entire amount of oil. Mix (shake) the fuel mixture. Add the remaining amount of petrol.
- Mix (shake) the fuel mixture thoroughly before filling the machine's fuel tank.
- Do not mix more than one month's supply of fuel at a time.

Fuel Handling

2.1 Fuel safety

Never start the machine:

- If you have spilt fuel on it. Wipe off the spillage and allow remaining fuel to evaporate.
- If you have spilt fuel on yourself or your clothes, change your clothes. Wash any part of your body that has come in contact with fuel. Use soap and water.
- If the machine is leaking fuel. Check regularly for leaks from the fuel cap and fuel lines.

2.2 Transport and Storage

- Store and transport the machine and fuel so that there is no risk of any leakage or fumes coming into contact with sparks or naked flames, for example, from electrical machinery, electric motors, electrical relays/ switches or boilers.
- When storing and transporting fuel always use approved containers intended for this purpose.
- When storing the machine for long periods the fuel tank must be emptied. Contact your local petrol station to find out where to dispose of excess fuel.
- Ensure the machine is cleaned and that a complete service is carried out before long - term storage.
- The transport guard must always be fitted to the cutting attachment when the machine is being transported or in storage.
- Secure the machine during transport.
- In order to prevent unintentional starting of the engine, the spark plug cap must always be removed during long - term storage, if the machine is not under close supervision and when performing all service measures.



Take care when handling fuel. Bear in mind the risk of fire, explosion and inhaling fumes.

2.3 Fuel

The machine is equipped with a two - stroke engine and must always been run using a mixture of petrol and two - stroke oil. It is important to accurately measure the amount of oil to be mixed to ensure that the correct mixture is obtained. When mixing small amounts of fuel, even small inaccuracies can drastically affect the ratio of the mixture.



Fuel and fuel fumes are highly inflammable and can cause serious injury when inhaled or allowed to come in contact with the skin. For this reason observe caution when handling fuel and make sure there is adequate ventilation.

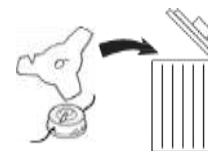

Check the cutting attachment for damage or cracks. A damaged cutting attachment should always be replaced.

4.2 Sharpening grass cutters and grass blades



Sharpen blades and cutters using a single - cut flat file.

Sharpen all edges equally to maintain the balance of the blade.



Always discard a blade that is bent, twisted, cracked, broken or damaged in any other way. Never attempt to straighten a twisted blade so that it can be reused. Only use original blades of the specified type.

4.3 Trimmer head

IMPORTANT Always ensure the trimmer cord is wound tightly and evenly around the drum, otherwise the machine will generate harmful vibration. Only use the recommended trimmer heads and trimmer cords. These have been tested by the manufacturer to suit a particular engine size. This is especially important when a fully automatic trimmer head is used. Only use the recommended cutting attachment.



Smaller machines generally require small trimmer heads and vice versa. This is because when clearing using a cord the engine must throw out the cord radially from the trimmer head and overcome the resistance of the grass being cleared.

The length of the cord is also important. A longer cord requires greater engine power than a shorter cord of the same diameter.

Make sure that the cutter on the trimmer guard is intact. This is used to cut the cord to the correct length.

To increase the life of the cord it can be soaked in water for a couple of days. This will make the line tougher so that it lasts longer.

Operating Instructions-KK-BC2-JP45

Prepare the Machine

1.1 Assembling the handlebar

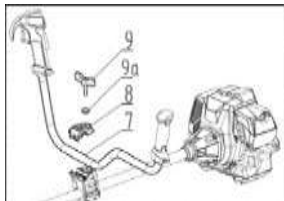

Loosen the locking screw (9) by turning it counter - clockwise, and then remove the locking screw, washer (9a) and clamping cover (8). Fit the handlebar (7) in the clamp on the shaft tube, and then reinstall clamping cover, washer and locking screw in reverse, tighten the locking screw securely.

1.2 Connecting the tube

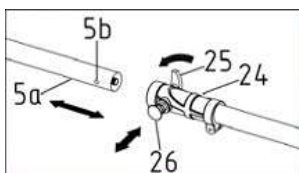

Align the hole (5b) on the front tube (5a) and the lock pin (26). Then, Pull out the Lock pin (26) and while inserting the front tube in the connector (24) to the end. After loosened the lock pin, it will return to its original position automatically, and insert into the hole on the front tube.

Make sure the front tube can't be rotated after the lock pin came back to its original position. Turn the lock knob (25) clockwise to tighten the front tube securely.

1.3 Fitting blades and trimmer heads



When fitting the cutting attachment it is extremely important that the raised section on the top clamping plate/support flange engages correctly in the Centre hole of the cutting attachment. If the cutting attachment is fitted incorrectly it can result in serious and/or fatal personal injury.

Never use a cutting attachment without an approved guard. If an incorrect or faulty guard is fitted this can cause serious personal injury. Wear gloves to avoid sharp edges of blade or other components to injury the operator while complete assembly

If a grass blade is to be used the machine must be equipped with the correct handlebar, blade guard and harness.

1.4 Fitting the guard extension

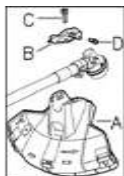

The guard extension shall always be fitted when using the trimmer head and combination guard. The guard extension shall always be removed when using the grass blade and combination guard.

Hook the blade guard/combination guard (A) onto the fitting (B) on the shaft and secure with a special bolt (C).

1.7 Fitting the trimmer guard and trimmer head

Fit the correct trimmer guard for use with the trimmer head.

CAUTION! Ensure that the guard extension is fitted.

Hook the trimmer guard/combination guard onto the fitting on the shaft and secure with three bolts.

Fit the top clamping plate (B) on the output shaft.

Turn the blade shaft until one of the holes in the top clamping plate aligns with the corresponding hole in the top protecting cap (C).

Insert the locking pin (A) in the hole to lock the shaft.

Screw on the trimmer head (D) in the opposite direction to the direction of rotation.

To dismantle, follow the instructions in the reverse order.

1.8 Adjusting the harness and brush cutter



When using a brush cutter it must always be hooked securely to the harness. Otherwise you will be unable to control the brush cutter safely and this can result in injury to yourself or others. Never use a harness with a defective quick release.

At the front is an easily accessible, quick release. Use this if the engine catches fire or in any other emergency situation that requires you to free yourself from the machine and harness.

A well - adjusted harness and machine makes work much easier. Adjust the harness for the best working position. Tension the side straps so that the weight is evenly distributed across both shoulders.

Adjust the shoulder strap so that the cutting attachment is parallel to the ground.

Let the cutting attachment rest lightly on the ground. Adjust the position of the suspension ring to balance the brush cutter correctly.

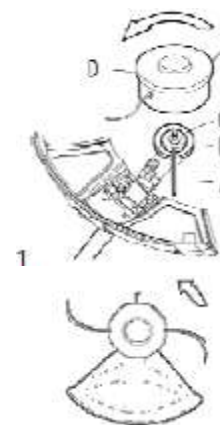

Enter the guard extension guide in the slot of the combination guard. Then click the guard extension into position on the guard with some claws.

The guard extension is removed easily using a screwdriver, see illustration.

1.6 Fitting a blade guard, grass blade and grass cutter.

Hook the blade guard/combination guard (A) onto the fitting (B) on the shaft and secure with a special bolt (C). Use the recommended blade guard. See the Technical data section.

CAUTION! Ensure that the guard extension is removed.

Fit the top clamping plate (B) on the output shaft. Turn the blade shaft until one of the holes in the top clamping plate aligns with the corresponding hole in the top protecting cap.

Insert the locking pin (A) in the hole to lock the shaft.

Place the blade (C), bottom clamping plate (D) and bottom protecting cap (E) on the output shaft.

Fit the nut (F). The nut must be tightened to a torque of 35 - 50 Nm (3.5 - 5 kpm). Use the socket spanner in the tool kit. Hold the shaft of the spanner as close to the blade guard as possible. To tighten the nut, turn the spanner in the opposite direction to the direction of rotation (Caution! left - hand thread).

Pull out the locking pin after all installation process has been finished.

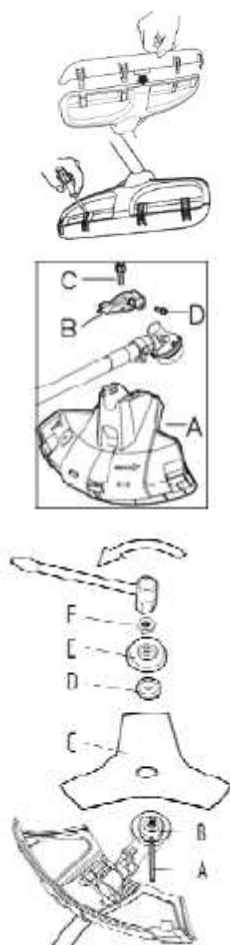

Enter the guard extension guide in the slot of the combination guard. Then click the guard extension into position on the guard with some claws.

The guard extension is removed easily using a screwdriver, see illustration.

1.5 Fitting a blade guard, grass blade and grass cutter

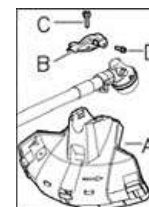

Hook the blade guard/combination guard (A) onto the fitting (B) on the shaft and secure with a special bolt (C). Use the recommended blade guard. See the Technical data section. CAUTION! Ensure that the guard extension is removed.

Fit the top clamping plate (B) on the output shaft.

Turn the blade shaft until one of the holes in the top clamping plate aligns with the corresponding hole in the top protecting cap. Insert the locking pin (A) in the hole to lock the shaft.

Place the blade (C), bottom clamping plate (D) and bottom protecting cap (E) on the output shaft.

Fit the nut (F). The nut must be tightened to a torque of 35 - 50 Nm (3.5 - 5 kpm). Use the socket spanner in the tool kit. Hold the shaft of the spanner as close to the blade guard as possible. To tighten the nut, turn the spanner in the opposite direction to the direction of rotation (Caution! left - hand thread).

Pull out the locking pin after all installation process has been finished.

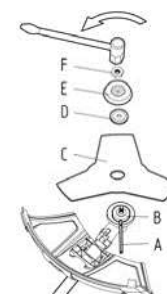

1.6 Fitting the trimmer guard and trimmer head



Fit the correct trimmer guard for use with the trimmer head.

CAUTION! Ensure that the guard extension is fitted.

Hook the trimmer guard/combination guard onto the fitting on the shaft and secure with three bolts.

Fit the top clamping plate (B) on the output shaft.

Turn the blade shaft until one of the holes in the top clamping plate aligns with the corresponding hole in the top protecting cap (C).

Insert the locking pin (A) in the hole to lock the shaft.

Screw on the trimmer head (D) in the opposite direction to the direction of rotation.

To dismantle, follow the instructions in the reverse order.

Operating Instructions-KK- SBC2-JP43

1) PREPARE THE MACHINE

1.1 Assembling the Front handle

Align the position hole (B1) on the clamp ring (B) with one position hole (A1) of three on the tube/ rear tube (A), and then fit the barrier (C) on the clamp ring, and while aligning hole on clamp ring and the groove on spacer block. (Fig. 1)

Align the position pin (D1) on the front handle (D) with the position hole (B1) on the clamp ring (B). (Fig. 2)

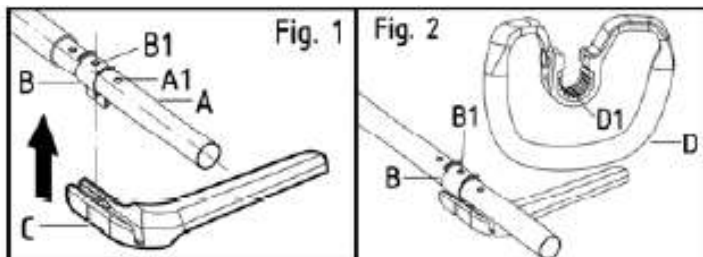

Push down the front handle (D) until the hole on the front handle aligned to the groove on the spacer block. (Fig. 3)

Insert the locking screw into the front handle, and then turn it clockwise to tighten the front handle. (Fig. 4)

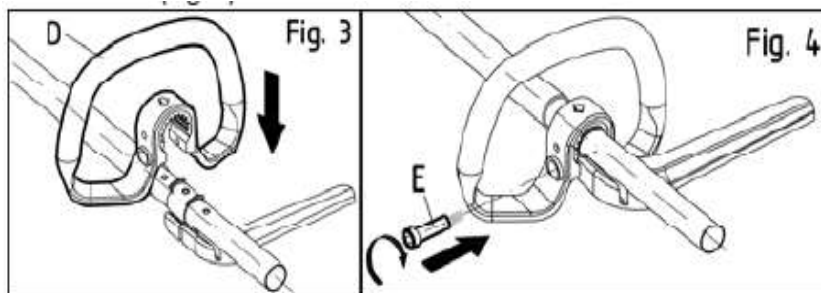

1.2 Assembling the flexible shaft

Pull out the locking pin (K). Align the flexible shaft (H) and the clutch (J), and insert the flexible shaft tube (G) into the clutch cover until the position hole (G1) align with the locking pin (K). Loosen the locking pin.

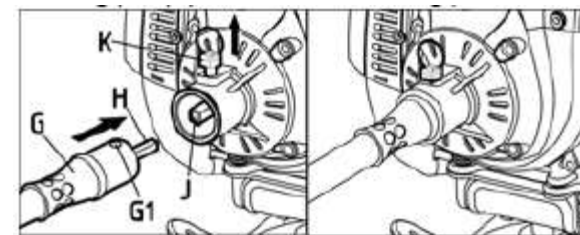

1.3 Connect the throttle cable

Connect the operation cable (L) and the throttle cable (M). Then close the throttle cable connector.

1.4 Fitting blades and trimmer heads

When fitting the cutting attachment it is extremely important that the raised section on the top clamping plate/support flange engages correctly in the center hole of the cutting attachment. If the cutting attachment is fitted incorrectly it can result in serious and/or fatal personal injury.

Never use a cutting attachment without an approved guard. See the chapter on Technical data. If an incorrect or faulty guard is fitted this can cause serious personal injury.

If a saw blade or grass blade are to be used the machine must be equipped with the correct handlebar, blade guard and harness.

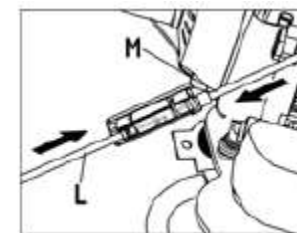

1.5 Fitting the guard extension

The guard extension shall always be fitted when using the trimmer head and combination guard. The guard extension shall always be removed when using the grass blade and combination guard.

Hook the blade guard/combination guard (A) onto the fitting (B) on the shaft and secure with a special bolt (C).

