

BODY**KK-BBS 315**

P-NO	KK-PART NAME
B-1	Container Cap
B-2	Air Intake Plug
B-3	Felt Washer(Container Cap)
B-4	Large Filter
B-5	Round Rod Clamp
B-6	Water Tank
B-7	The Belt For Battery
B-8	Lag/Battery Cover
B-9	Battery
B-10	Screw M4X18
B-11	Motor with Pump
B-12	Washer 4 Plain
B-13	Nut M4
B-14	Side Plate
B-15	Screw ST 2.9x8
B-16	Washer 3
B-17	Volt Meter
B-18	Voltage Regulator
B-19	The Line For Recharging
B-20	Power Switch
B-21	Pump Board (Bottom)
B-21-1	Pump Board (Upper)
B-22	Cover Plate
B-23	Washer 5 (Plain)
B-24	Screw M5x10
B-25	Fastening Buckle
B-26	Sholder Belt
B-27	Screw M5x10
B-28	Washer 6 Plain
B-29	Belt Pad
B-30	Hose Clamp (metal)
B-31	O Ring (Round Bar)
B-32	Absorb Pipe
B-33	Hose Clamp (Plastic)
B-34	Case Nut(water Pipe)
B-35	Rubber Washer
B-36	Water Pipe (Plastic)
B-37	Snap Link
B-38	Absorb Pipe (For Filter)

B-39	Little Filter
B-40	Hose
B-41	Switch Handle
B-42	Felt Washer(Switch Handle)
B-43	Switch Body
B-44	Press Plate
B-45	Switch Pin
B-46	Lock Catch
B-47	O-Ring 4.4X1.8(Pressure Shaft)
B-48	Pressure Shaft
B-49	Switch Felt Washer
B-50	Washer Seat
B-51	Spring(Trigger)
B-52	Switch Nut Washer
B-53	Switch Nut
B-54	Split Sleeve
B-55	Case Nut(Round Bar)
B-56	Round Bar
B-57	N/A
B-58	N/A
B-59	N/A
B-60	N/A
B-61	F Style Spray Head
B-62	Joint
B-63	Fan Style Spray Head
B-64	Charger
B-65	Circuit box
B-66	Spray Head
B-67	Trigger Assy

BBS-315/318
Electric sprayer machine diagram

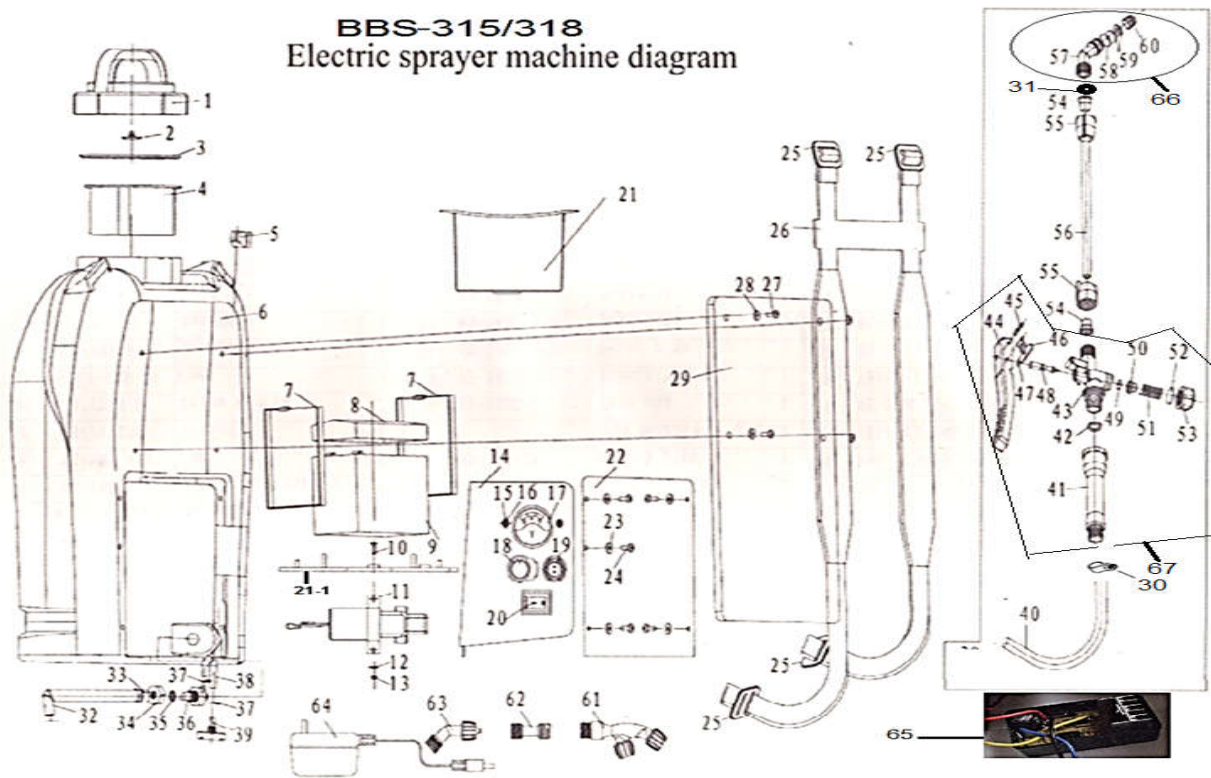

PUMP

P-NO	KK-PART NAME
P-1	Screw M4*12
P-2	Screw St2.9*13
P-3	Pressure valve lid
P-4	Micro Switch
P-5	Spring Seat
P-6	Pressure Spring
P-7	Pressure piston
P-8	Ring (Plastic)
P-9	Pressure rubber
P-10	Pump Body
P-11	Bearing move seat
P-12	Eccentric Shaft
P-13	Bearing 608-2RS
P-14	Screw M4*10
P-15	Motor holder
P-16	Motor
P-17	Motor cover
P-18	Motor Feet
P-19	Screw M4*25
P-20	Diaphragm

P-21	Inlet Valve Seat
P-22	Valve (inlet & outlet)
P-23	Valve Spring
P-24	Outlet Valve Seat
P-25	Pump Up Lid
P-26	Pump Down Lid
P-27	Screw St2.9*16
P-28	Lead Wire

