

6020/6522 Parts List		
KK-NO	KK-NAME	QTY
1	HAND GUARD	1
2	Bush Rubber(Hand Guard)	1
3	Bush Metal(Hand Guard)	1
4	Screw & washer 5x12 Trox	1
5	Cushion Rubber for Stud 5x25	1
6	STUD 5x25	1
7	CUSHION RUBBER(Cylinder)	1
8	SPARK PLUG	1
9.1	CYLINDER-6020	1
9.2	CYLINDER -6522	1
10	MUFFLER GASKET	2
11	COOLING PLATE(Muffler)	1
12	SCREWS M-8x53 Trox	2
13	MUFFLER COMP.	1
14	Screw M 5x32 Trox	5
15	CYLINDER GASKET	1
16	Screw M 5x25 Trox	4
17	Cushion Rubber (1)	2
18	OIL CAP COMP.	1
19	FAN COVER	1
20	STARTER HANDLE	1
21	STARTER COVER	1
22	BUSHING(STARTER COVER)	1
23	Rope Guide	1
24	STARTER ROPE	1
25	Plate (Recoil spring)	1
26	Re-coil spring	1
27	Rope reel	1
28	STARTER PAWL	2

29	Washer(Rope reel)	1
30	Lock(Rope reel)	1
31	Nut M8 Flanged	1
32	Wave washer (Clutch)	1
33	FLYWHEEL	1
34	Cushion Rubber (2)	1
35	OIL SEAL 15x22x4.5	1
36	BEARING 6202-2RS	1
37	Crankcase Left	1
38	Mouth Piece(Vaccum)	1
39	CRANKCASE GASKET	1
40	Locating Pin	2
41	Crankcase Right	1
42	STUD M8X42	2
43	CHECK VALVE	1
44	Bearing With Oil seal	1
45	TENSIONER SLIDE	1
46	SUPPORT(Chain Adjusting Screw)	1
47	Chain Adjusting Screw	1
48	O Ring 7.1X1.5(Chain Adjusting Gear)	1
49	Chain Adjusting Gear	1
50	Screw 4x5 Trox	1
51	Cover Plate (Chain Adjusting Gear)	1
52	INNER SIDE PLATE(Chain)	1
53	Oil Groove Rubber	1
54	Screw M4x5 Trox	1
55	Screw M5x16 Trox	2
56	SPIKE BUMPER	1
57	S T Screw	1
58	Guard Plate (Chain)	1
59	Insulation Al Foil (Small)	1
60	Pin(Break Lever)	1
61	Pin(Break Lever Small)	1

62	Pin(Spring Break Lever Small)	1
63	Pin (Hand Guard)	1
64	Pin(Break Spring)	1
65	Nut-M8x7 Flanged	2
66	CLUTCH COVER	1
67	Saw Dust Protector	1
68	CHAIN GUIDE	2
69	Screw M4x10 Trox	3
70	BRAKE SYSTEM COVER	1
71	BRAKE BAND	1
72	Pin 3x9	1
73	Screw 4x10 Trox	1
74	BRAKE RETURN SPRING	1
75	Brake Spring Sleeve	1
76	E-Ring(Break Lever)	2
77	BRAKE LEVER	1
78	Spring (Break Lever Small)	1
79	BRAKE LEVER Small	1
80	CUSHION RUBBER(3)	1
81.1	Piston Rings-6020	2
81.2	Piston Rings-6522	2
82.1	Piston -6020	1
82.2	Piston -6522	1
83	Needle Bearing(piston pin)	1
84	Cir clip (piston pin)	2
85	PISTON PIN	1
86	Key (Crankshaft)	1
87	CRANKSHAFT COMP.	1
88	Spiring Washer -8	2
89	OIL FILTER	1
90	OIL PUMP PIPE (IN)	1
91	OIL PUMP PIPE (OUT)	1
92	OIL PUMP COMP.	1

93	WORM	1
94	Screw M4x10 Trox	2
95	Cover Washer (Worm)	1
96	CLUTCH SPRING	3
97	CARRIER(Clutch)	1
98	CLUTCH SHOE	3
99	Clip Cluth	3
100	Clutch Shoe Assy	1
101	CLUTCH DRUM	1
102	Sprocket	1
103	Needle Bearing(Clutch)	1
104	Washer(Clutch Drum)	1
105	E-Ring(Clutch Drum)	1
106	FRONT HANDLE	1
107	DAMPER PLASTIC SEAT	1
108	CYLINDER DAMPING SPRING	1
109	Screw M5x12 Trox	1
110	ALLOY HEAD(DAMPING SPRING)	1
111	N/A	1
112	PROTECTION WIRE	1
113	S T Screw	2
114	S T Screw	2
115	SLOTTED NUT(Cyl cover)	1
116	RUBBER SLOTTED NUT	1
117	Insulation Al Foil (Big)	1
118	Shutter (Cylinder Cover)	1
119	CYLINDER COVER	1
120	COVER PLATE(Cylinder cover)	1
121	CUSHION RUBBER(Cylinder cover)	1
122	Air Baffel	1
123	PLUG(Air filter Housing)	1
124	Grommet Carb adjusting	1
125	S T Screw	2

126	Balance Pipe	1
127	HOSE CLIP	1
128	MANIFOLD	1
129	Sleeve(Mani fold)	1
130	CARBURETOR GASKET(Metal)	1
131	Screw Carburator	2
132	CARBURETOR	1
133	Air filter Housing	1
134	INLET TUBE	1
135	Filter (Inlet Tube)	1
136	Nut M5 Flanged	2
137	AIR FILTER	1
138	Air filter outside cover	1
139	Air filter Lock nut	1
140	REAR HANDLE COVER	1
141	Throttle Lock	1
142	THROTTLE TRIGGER	1
143	THROTTLE TRIGGER PIN	1
144	CHOKE KNOB	1
145	CHOKE LEVER RETURN SPRING	1
146	THROTTLE SPRING	1
147	THROTTLE ROD	1
148	REAR HANDLE COMP.	1
149	STOP SWITCH	1
150	FUEL CAP COMP.	1
151	DAMPING RUBBER SEAT	1
152	DAMPING BOLT CAP	1
153	SCREWS(DAMPING RUBBER SEAT)	1
154	Screw 4x18 Trox	2
155	Plastic Seat (Spring Bedding)	1
156	N/A	1
157	SPRING(Bedding)	1
158	DAMPING RUBBER BLOCK	1

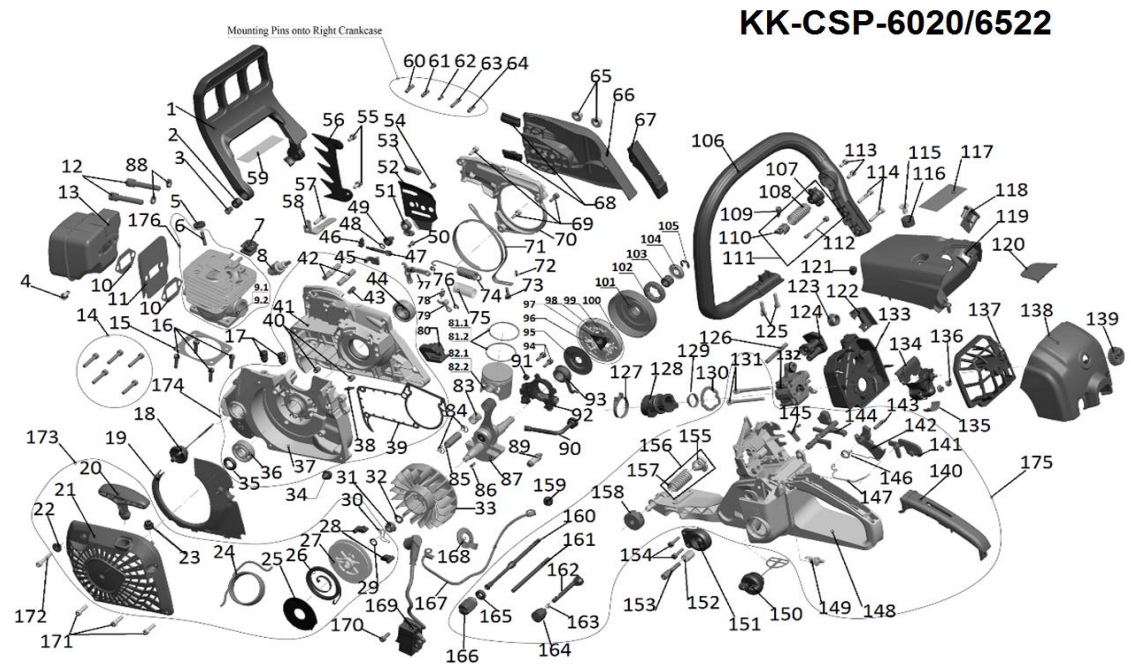

159	Grommet(cord on/off switch)	1
160	FUEL PIPE	1
161	Vaccum Tube	1
162	Hose For Breather	1
163	Pipe Clamp	1
164	BREATHER ASSY	1
165	Sleeve Metal for Fuel Pipe	1
166	FUEL FILTER	1
167	Cord for on/off switch	1
168	N/A	1
169	IGNITION COIL	1
170	Screw 5x18 Trox	2
171	Screw M5x25 Trox	3
172	Screw M5x32 Trox	1
173	Starter Assy	1
174	N/A	1
175	N/A	1
176	N/A	1
177	Bar-20" 3/8 0.063	1
177	Bar-22" 3/8 0.063	1
178	Chain-20" 75Lpx072x	1
178	Chain-22" 75Lpx076x	1